



1835
market street

CBRE



NIGHTINGALE
— PROPERTIES —

**A Class A
office building in the
heart of Center City
Philadelphia with
retail amenities,
public transportation
access, and ample
on-site parking**

FEATURES

- Prime location at 1800 block of Market Street
- Fully renovated lobby, digital kiosk, elevator cabs and systems, common area hallways and restrooms
- 686,503 SF, 29 story Class A Office
- LEED Silver Certified, Energy Star rated
- Efficient modern mechanical systems
- 24/7 building access and security
- On-site management office and conference facility on 17th floor
- On-Site banking, lobby shop, and Planet Fitness
- On-Site tenant only parking garage with 72 reserved spaces and 102 valet spaces
- Proximity to Local Walnut Street and Rittenhouse Square shopping, restaurants, and hotels

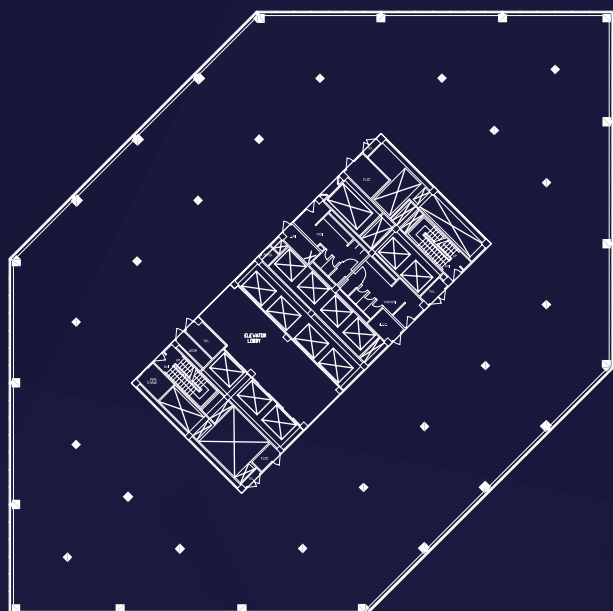



EFFICIENT FLOOR PLATES

26,313 SF/Floor

Maximum perimeter
window line

Suites range from
2,000-45,000 SF

AVAILABILITIES

29 TH FLOOR	1,898 SF
28 TH FLOOR	6,820 SF
27 TH FLOOR	13,403 SF
24 TH FLOOR	5,307 SF
23 TH FLOOR	26,313 SF
17 TH FLOOR	2,948 SF
17 TH FLOOR	2,232 SF
13 TH FLOOR	8,622 SF
12 TH FLOOR	15,559 SF
12 TH FLOOR	3,525 SF
11 TH FLOOR	9,378 SF
10 TH FLOOR	5,592 SF
9 TH FLOOR	25,235 SF
7 TH FLOOR	5,605 SF
7 TH FLOOR	5,301 SF
7 TH FLOOR	1,412 SF
6 TH FLOOR	1,198 SF
5 TH FLOOR	5,725 SF
4 TH FLOOR	10,140 SF



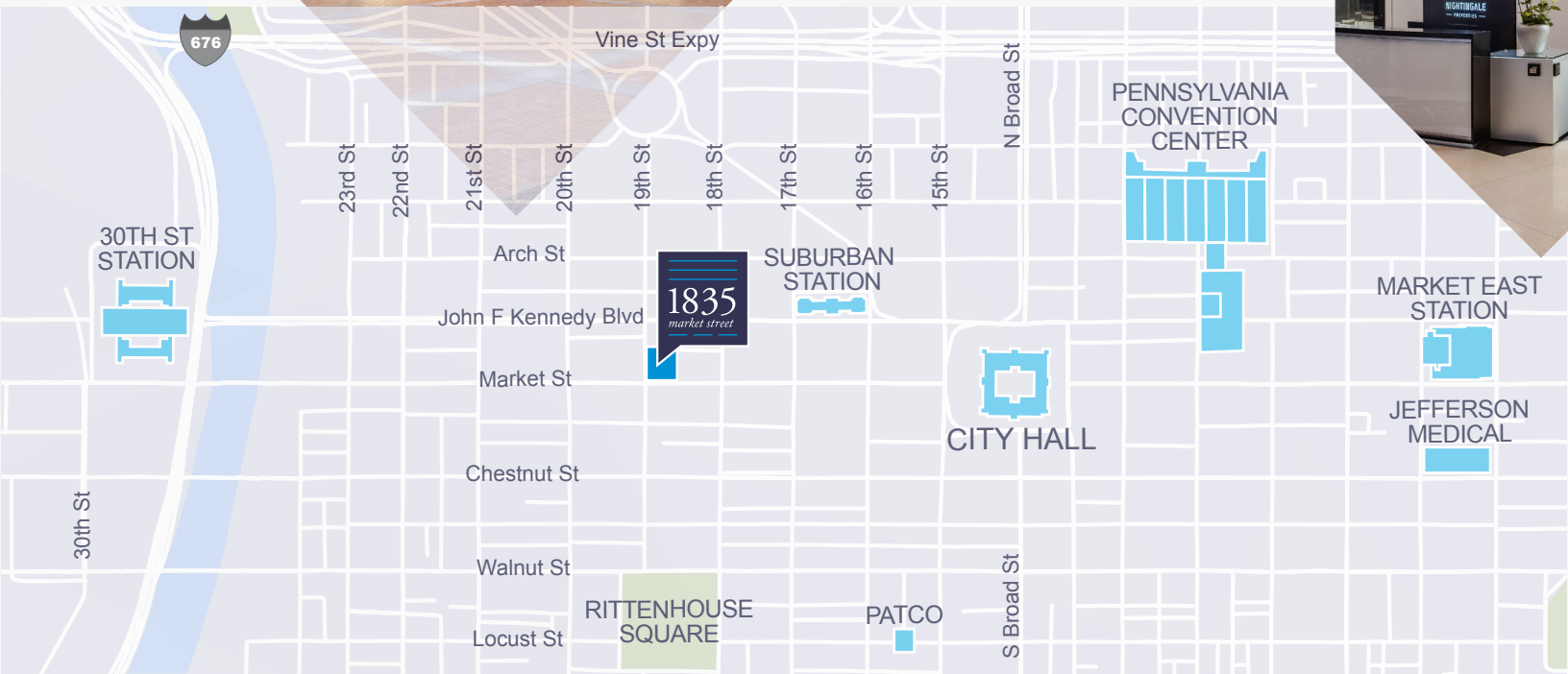

For information, contact:

GEORGE CAUFFMAN, III
T +1 215 561 8934
george.cauffman@cbre.com
Licensed: PA
Licensed Salesperson: NJ

KEVIN M. MALONEY
T +1 215 561 8947
kevin.maloney@cbre.com
Licensed: PA

MARK W. ADZICK
T +1 215 561 8956
mark.adzick@cbre.com
Licensed: PA

CBRE, INC.
Two Liberty Place
50 South 16th Street
Suite 3000
Philadelphia, PA 19102
T +1 215 561 8900
F +1 215 557 6719
cbre.us/philadelphia
Licensed Real Estate Broker

CBRE



© 2021 CBRE, Inc. All rights reserved. This information has been obtained from sources believed reliable, but has not been verified for accuracy or completeness. You should conduct a careful, independent investigation of the property and verify all information. Any reliance on this information is solely at your own risk. CBRE and the CBRE logo are service marks of CBRE, Inc. All other marks displayed on this document are the property of their respective owners. Photos herein are the property of their respective owners. Use of these images without the express written consent of the owner is prohibited.